

Saddle for PVC/PE pipes Series 1300



MATERIAL: GGG 40

USE: PVC and PE pipes

- The LEYA saddle allows full screwing, therefore guaranteeing complete watertightness. It is made of GGG 40 ductile cast iron, approx. 120 to 180 micron resin coated.
- Watertight gasket: EPDM, according to UNE EN 681/1.
- Fitted with stainless steel bolts A2-DIN 933 and stainless steel washers AISI 304 - DIN 125.

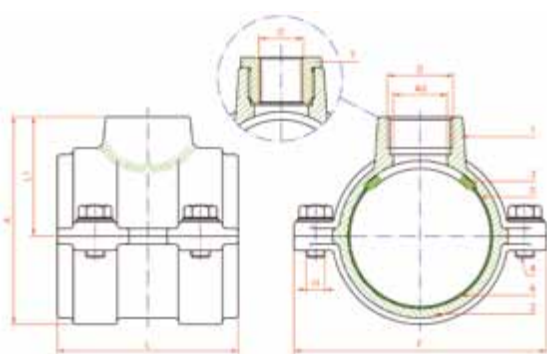

REF.	Ø PIPE	D 1/2"	d	L	L1	A	F	H	WEIGHT Kg
1301-0012	32	1/2"	15	65	39	65	91	M8x20	0.8
1302-0034	32	3/4"	20	65	39	65	91	M8x20	0.8
1303-0012	40	1/2"	15	65	42	82	99	M8x20	1
1304-0034	40	3/4"	20	65	45	85	99	M8x20	1
1305-1000	40	1"	26	65	51	91	99	M8x20	1
1306-0034	50	3/4"	20	90	50	85	114	M10x25	1.4
1307-1000	50	1"	26	90	56	91	114	M10x25	1.4
1308-0014	50	1 1/4"	34	90	56	91	114	M10x25	1.4
1309-0034	63	3/4"	20	90	56	98.5	129	M10x25	1.7
1309-1000	63	1"	26	90	62	104.5	129	M10x25	1.7
1310-1014	63	1 1/4"	34	90	62	104.5	129	M10x25	1.7
1311-1012	63	1 1/2"	40	90	70	110.5	129	M10x25	1.7
1312-2000	63	2"	52	90	70	110.5	129	M10x25	1.7
1313-1000	75	1"	26	115	68	116.5	141	M10x25	2.3
1314-1014	75	1 1/4"	34	115	68	116.5	141	M10x25	2.3
1315-1012	75	1 1/2"	40	115	76	124.5	141	M10x25	2.3
1316-2000	75	2"	52	115	76	124.5	141	M10x25	2.3
1317-1000	90	1"	26	115	76	132	161	M12x25	2.8
1318-1014	90	1 1/4"	34	115	76	132	161	M12x25	2.8
1319-1012	90	1 1/2"	40	115	83	139	161	M12x25	2.8
1320-2000	90	2"	52	115	83	139	161	M12x25	2.8
1321-1000	110	1"	26	115	86	153	189	M12x25	3.5
1322-1014	110	1 1/4"	34	115	86	153	189	M12x25	3.5
1323-1012	110	1 1/2"	40	115	93	160	189	M12x25	3.5
1324-2000	110	2"	52	115	93	160	189	M12x25	3.5
1325-1000	125	1"	26	115	93	167.5	204	M12x25	3.8
1326-1014	125	1 1/4"	34	115	93	167.5	204	M12x25	3.8
1327-1012	125	1 1/2"	40	115	100	174.5	204	M12x25	3.8
1328-2000	125	2"	52	115	100	174.5	204	M12x25	3.8
1329-1000	140	1"	26	140	101	183	219	M12x25	4.7
1330-1014	140	1 1/4"	34	140	101	183	219	M12x25	4.7
1331-1012	140	1 1/2"	40	140	108	190	219	M12x25	4.7
1332-2000	140	2"	52	140	108	190	219	M12x25	4.7
1333-1000	160	1"	26	140	111	203	239	M12x25	5.2
1334-1014	160	1 1/4"	34	140	111	203	239	M12x25	5.2
1335-1012	160	1 1/2"	40	140	118	210	239	M12x25	5.2
1336-2000	160	2"	52	140	118	210	239	M12x25	5.2
1337-1000	180	1"	26	180	121	223	259	M12x25	7.7
1338-1014	180	1 1/4"	34	180	121	223	259	M12x25	7.7
1339-1012	180	1 1/2"	40	180	128	230	259	M12x25	7.7
1340-2000	180	2"	52	180	128	230	259	M12x25	7.7
1341-1000	200	1"	26	180	131	243	279	M12x25	8
1342-1014	200	1 1/4"	34	180	131	243	279	M12x25	8
1343-1012	200	1 1/2"	40	180	138	250	279	M12x25	8
1344-2000	200	2"	52	180	138	250	279	M12x25	8
1345-1000	225	1"	26	180	143	267.5	304	M12x25	9
1346-1014	225	1 1/4"	34	180	143	267.5	304	M12x25	9
1347-1012	225	1 1/2"	40	180	151	275.5	304	M12x25	9
1348-2000	225	2"	52	180	151	275.5	304	M12x25	9
1349-1000	250	1"	26	180	156	293	329	M12x25	9.8
1350-1014	250	1 1/4"	34	180	156	293	329	M12x25	9.8
1351-1012	250	1 1/2"	40	180	163	300	329	M12x25	9.8
1352-2000	250	2"	52	180	163	300	329	M12x25	9.8
1353-1000	280	1"	26	180	171	323	359	M12x25	10.6
1354-1014	280	1 1/4"	34	180	171	323	359	M12x25	10.6
1355-1012	280	1 1/2"	40	180	178	330	359	M12x25	10.6
1356-2000	280	2"	52	180	178	330	359	M12x25	10.6
1357-1000	315	1"	26	180	188	357.5	394	M12x25	13
1358-1014	315	1 1/4"	34	180	188	357.5	394	M12x25	13
1359-1012	315	1 1/2"	40	180	196	365.5	394	M12x25	13
1360-2000	315	2"	52	180	196	365.5	394	M12x25	13

OUTLET						
Ø mm	1/2"	3/4"	1"	1 1/4"	1 1/2"	2"
25	X	X	X	X	X	X
32	•	•	X	X	X	X
40	•	•	•	X	X	X
50	○	•	•	•	X	X
63	○	•	•	•	•	•
75	○	○	•	•	•	•
90	○	○	•	•	•	•
110	○	○	•	•	•	•
125	○	○	•	•	•	•
140	○	○	•	•	•	•
160	○	○	•	•	•	•
180	○	○	•	•	•	•
200	○	○	•	•	•	•
225	○	○	○	○	○	•
250	○	○	○	•	○	•
280	○	○	○	○	○	•
315	○	○	○	○	○	•

- Standard design
- Available with reduction nut